

CORNER RESTORATION

S ¼ Cor.
CORNER Sec. 12 TWP 13 S. RANGE 33 E.

ORIGINAL SURVEY BY: John B. David

CONTRACT NUMBER: 131

CONTRACT DATE: June 8, 1869

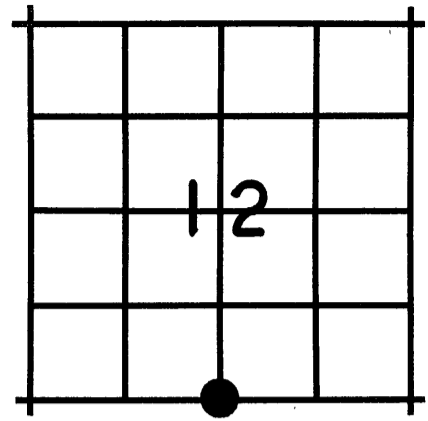

ORIGINAL DESCRIPTION:

GLO NOTES: Set Stone 16x8x8 for 1/4 section corner
Grant County Surveyor L.A. McKeown states in Surveyor's Record Book "A",
Page 117: From the S.E. corner of Section 12, T. 13 S., R. 33 E., W.M.,
run west 40.20 chains established 1/4 corner. Dated April 21 & 22, 1806.
NOTE: No monument description given by McKeown.

RESTORATION BY, STAMP AND DATE:

R. D. Bagett
J. L. Watson
K. J. Workman

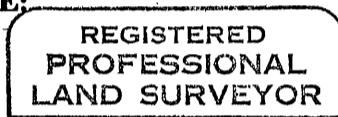

Robert D. Bagett
OREGON
JULY 12, 1969
ROBERT D. BAGETT
598

August 10, 1988

RECEIVED AND
FILED

SEP 2 1988

OFFICE OF COUNTY SURVEYOR
Robert D. Bagett
Attest: *John B. David*

Grant County Surveyor

EVIDENCE FOUND:

I found a 5/8"x24" Galv. iron pipe set 14" in the ground at the corner of fences running N-E-W. This monument is identical to another 5/8" Galv. iron pipe found at the C 1/4 corner of Sec. 12; which was also established by McKeown, then found and described by Vernon Glaze in 1915, Miscellaneous records, Book 2, Pages 496-505. This position is also harmoniously related to other known corners in the area. I found no evidence of the original corner stone. I accept the position of McKeown's iron pipe for this 1/4 corner.

See Record Map of Survey No. 1037.

DESCRIPTION OF MONUMENTS AND ACCESSORIES SET AND METHODS USED:

Show how trees are scribed and basis of bearings, including compass var.

At the Corner Point: Set a 1½"x30" galvanized iron pipe 27 inches in the ground with Brass Cap marked as shown. From which I set new Reference Points:
A 1/2"x24" iron pin, driven flush with the ground, bears North, 20.00 feet. (No Marks) Set in N-S fence line.

A 5/8"x30" iron pin, driven flush with the ground, bears S.89 1/2° E., 20.00 feet with attached yellow plastic cap marked "BGA SURVEY MARKER". Set in E-W fenceline.

Placed McKeown's 5/8" iron pipe inside my 1½" iron pipe and surrounded pipe with mound of stone 2 foot Base to top of cap.

Used magnetic compass with 18° E. Var. and steel tape for measurements to Reference Points.

No Bearing Trees or Bearing Objects available.

MONUMENT MARKED

